

± 2,200 SQ FT AVAILABLE  
**TULLY PLAZA**

1692 Tully Road unit 8A & 8B

San Jose, CA 95133



## PROPERTY HIGHLIGHTS:

- ±2,200 sf - divisible to two units ±1,100 sf
- Renovated medical/dental/professional office  
With marble floors, new interiors/carpet, and bathroom
- Each unit features 3 exam rooms, 1 office,  
Separate bathroom, reception area, and storage
- Previously occupied for 10+ year by busy internist  
And dentist
- Easy access to hwy 101, 280, and 680
- Ideal for any medical or dental practitioners

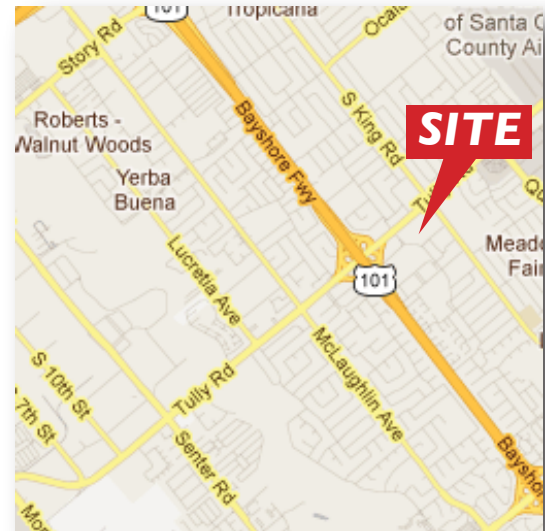

**Please contact the following agent for more information:**

**JEFF VO**

(408) 680.6340

jeff@GDcommercial.com

CA Lic# 01441068



1455 McCarthy Blvd.

Milpitas, CA 95035

Tel: 408.955.9900

Fax: 408.383.9887

www.GDCommercial.com

**±2,200 SF**  
**(Divisible)**

**1692 Tully Road Suite 8A & 8B**  
**San Jose CA**

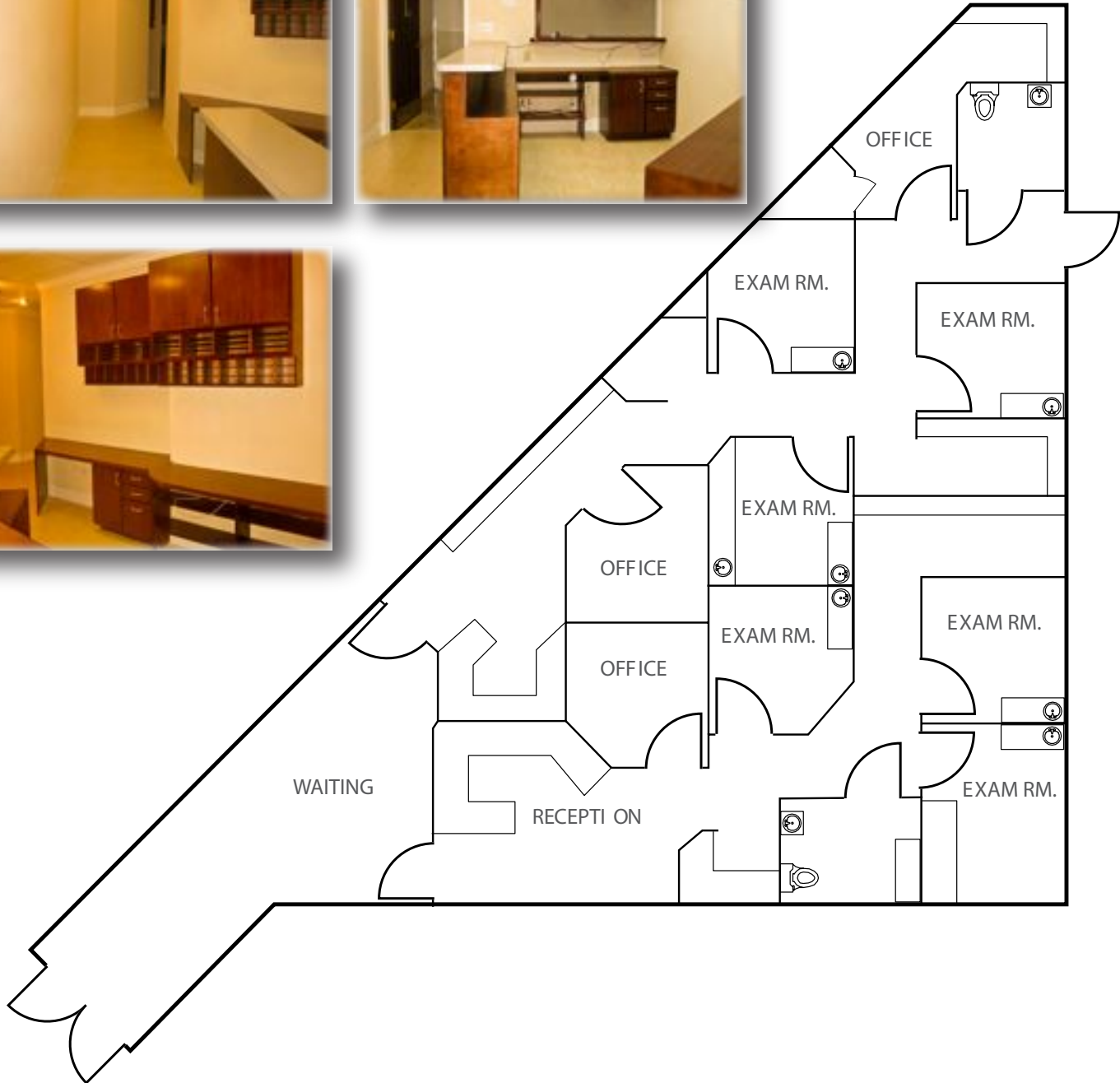

1455 MCCARTHY BLVD.  
MILPITAS, CA 95035  
www.GDComemrcial.com  
Tel: 408.955.9900  
Fax: 408.383.9887

**For more information, please contact:**

**Jeff Vo**  
**408.680.6340**  
CA DRE# 01441068